



Addendum No. 1
City of Coquitlam
Tender No. 72497
Johnson MUP and Atlantic Sidewalk Rehabilitation
 (Consists of 8 Pages)

Issue Date: April 22, 2026

Tenderers shall note the following changes:

Revisions

1. Refer to: FORM OF TENDER

Remove: Appendix 1
Replace with: *Revised* - Appendix 1 - *Revision No. 1*

2. Refer to: AGREEMENT, Schedule 2, List of Drawings

Remove:

TITLE	SHEET NO.	REVISION NO.	DATE
ROADWORKS - PLAN	03	0	2026-03-31
ROADWORKS - PLAN	04	0	2026-03-31
ROADWORKS - PLAN	05	0	2026-03-31
ROADWORKS - PLAN	06	0	2026-03-31

Replace with:

TITLE	SHEET NO.	REVISION NO.	DATE
<i>ROADWORKS - PLAN</i>	<i>03</i>	<i>1</i>	<i>2026-04-21</i>
<i>ROADWORKS - PLAN</i>	<i>04</i>	<i>1</i>	<i>2026-04-21</i>
<i>ROADWORKS - PLAN</i>	<i>05</i>	<i>1</i>	<i>2026-04-21</i>
<i>ROADWORKS - PLAN</i>	<i>06</i>	<i>1</i>	<i>2026-04-21</i>

Questions & Clarifications

Q1) Pay item 18.01, Structural Soil is measured in tonnes, with Measure and Payment specified to be by weight tickets. Structural soil suppliers do not provide weight tickets with their materials – they provide volume measurement tickets. Can the measurement of this pay item be changed to cubic meters, to properly reflect the material measurements that will be provided by suppliers?

A1) Please see *Revised – Appendix 1 – Revision No. 1* for changes to payment item.

Q2) The arborist report shows tree fencing along Johnson Street, but the SOQ does not have any tree fence item for Johnson. Can you confirm that no tree fencing will be required along Johnson Street?

A2) Tree protection fencing will be required on Johnson Street. Please see revised drawings and *Revised – Appendix 1 – Revision No.1*.

Q3) Can the tender closing date be extended?

A3) At this point in time, the City will not be extending the Closing Date. Closing date remains the same, April 24, 2026. Please monitor the City's website for further addenda.

End of Addendum No. 1

Tenderers shall take into account the content of this Addendum in the preparation and submission of the Tender which will form part of the contract and should be acknowledged on the Tender form where indicated.

Upon submitting a Tender, Tenderers will be deemed to have received all addenda and considered the information for inclusion in the Tender submitted.

Issued by:

M. Pain
Manager Procurement
Email: bid@coquitlam.ca

Revised - APPENDIX 1 - Revision No.1
FORM OF TENDER

Contract 72497
Johnson MUP and Atlantic Sidewalk Rehabilitation

SCHEDULE OF QUANTITIES AND PRICES

(see paragraph 5.3.1 of the Instruction to Tenderers)

(All Tender and Contract Prices shall NOT include GST. GST will apply upon payment)

(Should there be any discrepancy in the information provided, the City's original file copy shall prevail)

ITEM NO.	MMCD Ref. / (Supplementary Contract Specifications)	DESCRIPTION	UNIT	QTY	UNIT PRICE	EXTENDED AMOUNT
1.0	01 55 005	TRAFFIC CONTROL, VEHICLE ACCESS AND PARKING				
1.01	(1.5.1)	Traffic Control and Management				Incidental to Contract
2.0	01 57 015	ENVIRONMENTAL PROTECTION				
2.01	(1.6.1)	ESC Supply & Installation, Maintenance and Removal				Incidental to Contract
JOHNSON STREET (GLEN DRIVE - BARNET HWY)						
3.0	01 58 015	PROJECT IDENTIFICATION				
3.00	(1.3.1)	Construction Zone Information Signs	ea.	4		
3.01	(1.3.2)	CMS Board x 1	month	2		
4.0	31 11 015	CLEARING AND GRUBBING				
4.01	(1.4.1)	Clearing and Grubbing (including Tree Removals)	LS	1		
5.0	31 11 415	SHRUB AND TREE PRESERVATION				
5.01	1.3.1	Tree Protection incl. Tree Protection Fencing as per COQ-R26	lin.m	75		
6.0	31 24 135	ROADWAY EXCAVATION, EMBANKMENT AND COMPACTION				
6.01	(1.8.4)	Removal and Disposal of Asphalt Flat Works	sq.m	525		
6.02	(1.8.5)	Common Excavation including Off Site Disposal	cu.m	739		
6.03	(1.8.10)	Over Excavation Includes Excavation, Off Site Disposal, Backfill Material, Grading & Compaction) - Provisional	cu.m	10		
7.0	32 11 16.15	GRANULAR SUBBASE				
7.01	(1.4.3)	75mm Crushed Granular Subbase	tonne	772		
8.0	32 11 235	GRANULAR BASE				
8.01	(1.4.3)	19mm Crushed Granular Base	tonne	304		
9.0	32 12 165	HOT MIX ASPHALT CONCRETE PAVING				
9.01	(1.5.3)	50mm Asphalt MUP - MMCD Upper Course #2	tonne	75		
10.0	32 91 215	TOPSOIL AND FINISH GRADING				
10.01	(1.4.1)	Imported Topsoil (150mm)	cu.m	35		
11.0	32 92 235	SODDING				
11.01	(1.8.1)	Sodding	sq.m	222		
ATLANTIC AVENUE (PACIFIC ST - BALDWIN ST)						
12.0	01 58 015	PROJECT IDENTIFICATION				
12.01	(1.3.1)	Construction Zone Information Signs	ea.	4		
13.0	03 30 205	CONCRETE WALKS, CURBS AND GUTTERS				
13.01	(1.4.5)	Concrete Sidewalk & Boulevard - 100mm thick – Broom Finished c/w 100mm Granular Base, and as shown and described in the Contract Documents	sq.m	295		
14.0	31 11 015	CLEARING AND GRUBBING				
14.01	(1.4.1)	Clearing and Grubbing	LS	1		
15.0	31 11 415	SHRUB AND TREE PRESERVATION				
15.01	1.3.1	Tree Protection incl. Tree Protection Fencing as per COQ-R26	lin.m	45		
15.02	(1.3.2)	Hydro Excavation - Provisional	Allowance		\$30,000.00	\$30,000.00
15.03	(1.3.3)	Remove and Dispose of Existing Tree Grates	each	11		
16.0	31 24 135	ROADWAY EXCAVATION, EMBANKMENT AND COMPACTION				
16.01	(1.8.4)	Removal and Disposal of Concrete Pavers and Concrete Flat Works	sq.m	295		
16.02	(1.8.5)	Common Excavation including Off Site Disposal	cu.m	88		
16.03	(1.8.10)	Over Excavation Includes Excavation, Off Site Disposal, Backfill Material, Grading & Compaction) - Provisional	cu.m	10		
17.0	32 11 16.15	GRANULAR SUBBASE				
17.01	(1.4.3)	75mm Crushed Granular Subbase	tonne	42		
18.0	32 12 33	SURFACE TREATMENTS				
18.01	1.5.1	Romex Tree Pit - 50mm Thick - Romex Profi-DEKO c/w 9mm Clear Crush	sq.m	30		
19.0	32 91 13.235	STRUCTURAL SOIL				
19.01	(1.8.1)	Structural Soil within Critical Root Zone of Existing Trees (Includes Geogrid)	cu.m	40		

ITEM NO.	MMCD Ref. / (Supplementary Contract Specifications)	DESCRIPTION	UNIT	QTY	UNIT PRICE	EXTENDED AMOUNT
ATLANTIC AVENUE AND THE HIGH STREET						
20.0	01 58 015	PROJECT IDENTIFICATION				
20.01	(1.3.1)	Construction Zone Information Signs	ea.	4		
20.02	(1.3.3)	"Businesses Open Signage"	ea.	2		
21.0	03 30 205	CONCRETE WALKS, CURBS AND GUTTERS				
21.01	(1.4.3)	Concrete Curb and Gutter - MMCD C4	lin.m	2		
21.02	(1.4.3)	Concrete Curb and Gutter - MMCD C5	lin.m	22		
21.03	(1.4.3)	Concrete Curb and Gutter - Reversed MMCD C5	lin.m	10		
21.04	(1.4.3)	Concrete Curb and Gutter - MMCD C6	lin.m	29		
21.05	(1.4.5)	Concrete Sidewalk - 100mm thick – Broom Finished c/w 100mm Granular Base, and as shown and described in the Contract Documents	sq.m	75		
21.06	(1.4.5)	Stamped Concrete Median Infill - 100mm thick (incl. granular base)	sq.m	30		
21.07	(1.4.5)	Concrete Wheelchair Letdown as per COQ-C9C	ea.	4		
21.08	(1.4.10)	Tactile Strip - 24in x 60in - Access Tile, Yellow Colour, Removable Type	ea.	4		
22.0	31 11 415	SHRUB AND TREE PRESERVATION				
22.01	1.3.1	Tree Protection incl. Tree Protection Fencing as per COQ-R26	lin.m	25		
23.0	31 24 135	ROADWAY EXCAVATION, EMBANKMENT AND COMPACTION				
23.01	(1.8.4)	Removal and Disposal of Existing Curb	lin.m	20		
23.02	(1.8.4)	Removal and Disposal of Concrete Flat Works	sq.m	180		
23.03	(1.8.4)	Removal and Disposal of Existing Planters (including Curb Base, Allan Blocks, Topsoil, Landscaping and Delineators)	LS	1		
23.04	(1.8.5)	Common Excavation including Off Site Disposal	cu.m	78		
23.05	(1.8.10)	Over Excavation Includes Excavation, Off Site Disposal, Backfill Material, Grading & Compaction) - Provisional	cu.m	10		
24.0	32 11 235	GRANULAR BASE				
24.01	(1.4.3)	19mm Granular Base (Variable Thickness) - Provisional	tonne	46		
25.0	32 12 165	HOT MIX ASPHALT CONCRETE PAVING				
25.01	(1.5.1)	Asphaltic Concrete Paving - MMCD Upper Course #1 (50mm)	tonne	7		
25.02	(1.5.1)	Asphaltic Concrete Paving - MMCD Lower Course #1 (75mm)	tonne	11		
26.0	32 17 235	PAINTED PAVEMENT MARKINGS				
26.01	(1.5.3)	Supply and Installation of Thermoplastic Pavement Markings as shown in the Contract Drawings	LS	1		
26.02	(1.5.4.2)	Relocate Existing Signage	each	1		
27.0	33 44 015	MANHOLES AND CATCHBASINS				
27.01	(1.5.3.2)	Manhole Adjustment Only	each	1		

Total Tendered Price (exclude GST): _____

(Transfer the amount to Form of Tender Summary Page 1)

Name of Contractor: _____

BENCHMARK:
 MONUMENT 93H1001
 N: 5460550.827 E: 51617.196
 ELEV. = 17.923M (CVD28GVRD2018)

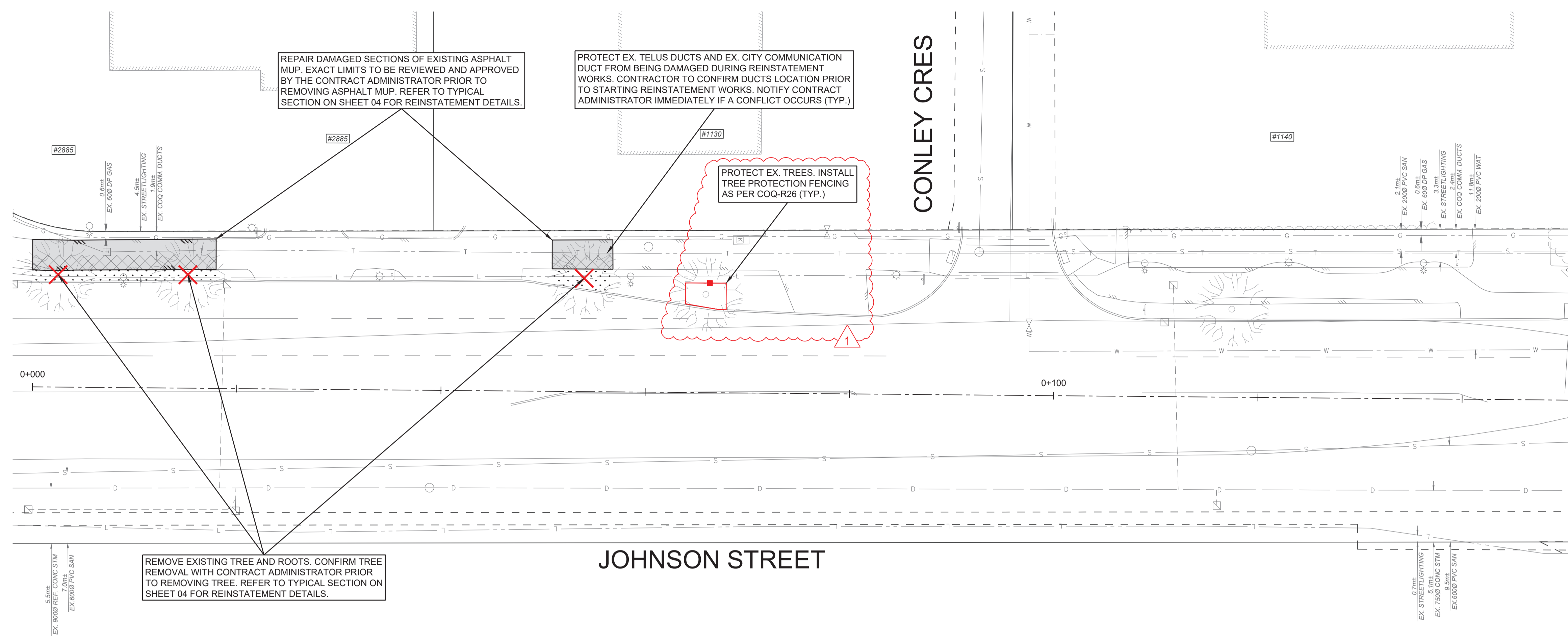

MATCH LINE FOR CONTINUATION SEE BELOW



LEGEND:

- REMOVE EX. ASPHALT AND EXCAVATE 900mm (MIN.). REMOVE TOP SOIL AND STRUCTURAL SOIL AS DIRECTED BY CONTRACT ADMINISTRATOR AND REPLACE WITH 835 mm (MIN.) THICK - 19mm GRANULAR BASE. PAVE 65mm THICK - UC#2 ASPHALT MUP. REFER TO TYPICAL SECTION ON SHEET 04 FOR DETAILS.
- REMOVE EX. ASPHALT, EXCAVATE 135mm AND PLACE 135mm THICK - 19mm GRANULAR BASE. PAVE 65mm THICK - UC#2 ASPHALT MUP. REFER TO TYPICAL SECTION ON SHEET 04 FOR DETAILS.
- EXCAVATE 900mm (MIN.) AND REMOVE EX. GROWING MEDIUM AS DIRECTED BY CONTRACT ADMINISTRATOR AND REPLACE WITH 750mm (MIN.) THICK - 19mm GRANULAR BASE AND 150mm THICK TOP SOIL AND SOD. REFER TO TYPICAL SECTION ON SHEET 04 FOR DETAILS.
- REMOVE EX. TREE
- TREE PROTECTION FENCING

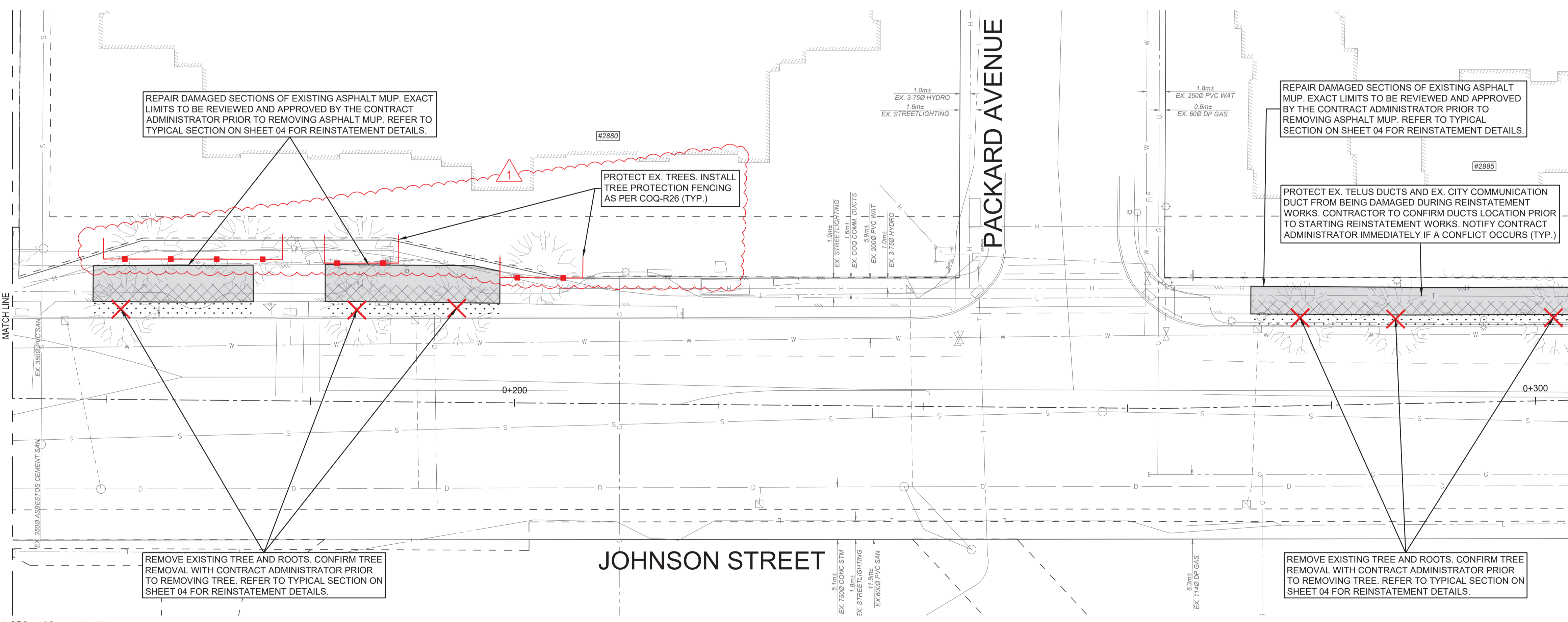

MATCH LINE FOR CONTINUATION SEE SHEET 04



0 10m H 1:250 V 1:25
 0 1m
 DISCLAIMER: This drawing must not be reproduced without the written permission of R.F. Binnie & Associates Ltd. This drawing is not to be used for construction unless it is stamped "ISSUED FOR CONSTRUCTION" and signed by R.F. Binnie & Associates Ltd. It is the contractor's responsibility to ensure that he is in possession of the latest revision of this drawing.

Edge of pavement	Hydrant	Sanitary service	Hydro Guy Wire
Watermain and valve	Water air valve	Sanitary cleanout	Hydro Kiosk
Drainage sewer, MH	Water blowoff	Utility pole (joint pole)	Vegetation Canister
Drainage ditch	Water service	Utility pole with light	Vegetation Deciduous
Sanitary sewer, MH	Catch basin, top inlet	Streetlight, down	Vegetation Shrub
Sanitary forcemain	Catch basin, side inlet	Streetlight, post top	Survey Traverse Hub
Gasmain and valve	Catch basin, round	Comb signal pole	Survey Iron Pin
Hydro duct, MH	Drainage service	Traffic signal pole	Survey Lead Plug
Telephone duct, MH	Drainage cleanout	Junction box	Survey Monument

No.	Date	By	Revisions
1	2026-04-21	PP	ADDENDUM 1
0	2026-03-31	PP	ISSUED FOR TENDER

Design by	Date
PP	2026-01-15
Drawn by	Date
MK	2026-01-13
Checked by	Date
WC	2026-03-31
Approved by	Date
KD	2026-01-30

BINNIE
 The people behind your infrastructure.
 TEL 604 420 1721 BINNIE.com

Coquitlam
 Engineering & Public Works
 3000 Guildford Way, Coquitlam, B.C. V3B 7N2

Scale horiz. 1:250 Scale vert. 1:25
 Sheet 03 of 06
 Eng. Project No. 25-0704

Project **JOHNSON STREET MUP REHABILITATION**
 Description **ROADWORKS - PLAN**
 File: 25-0704-R1-1
 REV. 1

EGBC PERMIT No. 1001128
ADDENDUM 1

BENCHMARK:
 MONUMENT 93H1001
 N: 5460550.827 E: 51617.196
 ELEV. = 17.923M (CVD28GVRD2018)

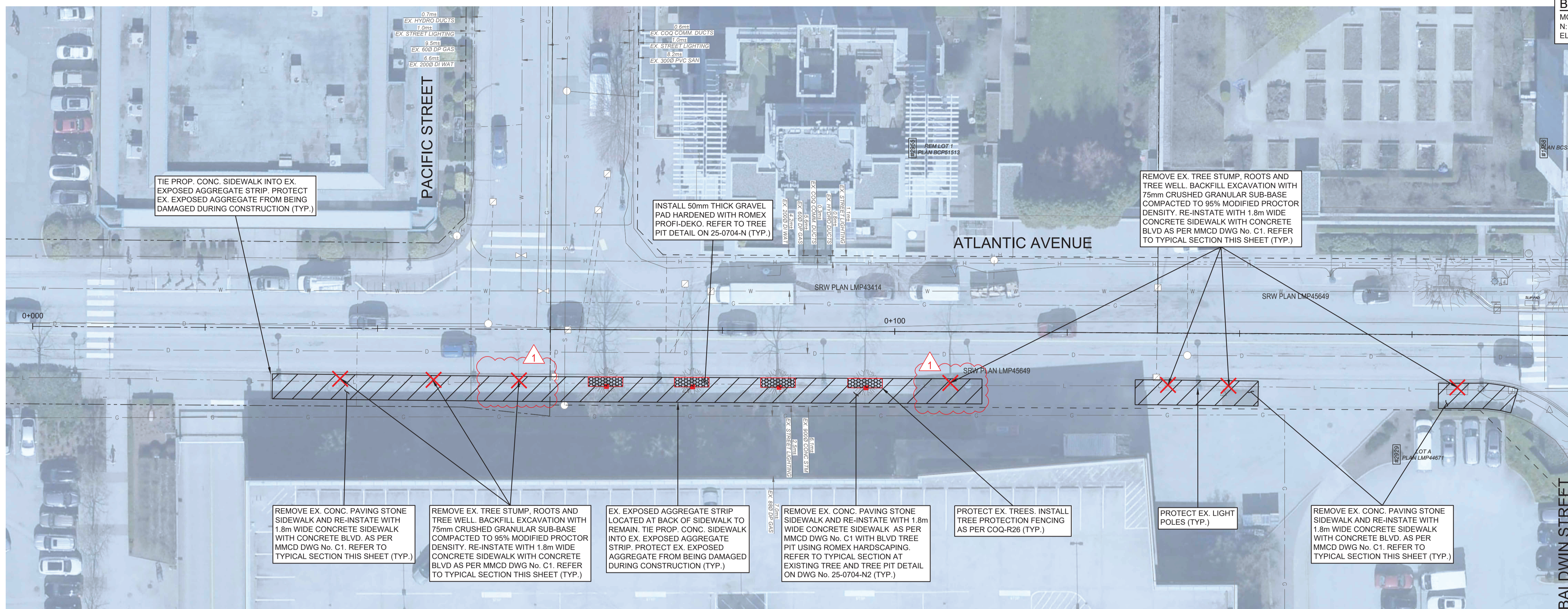

LEGEND:

- REMOVE EX. TREE STUMP, ROOTS AND TREE WELL
- TREE PROTECTION FENCING

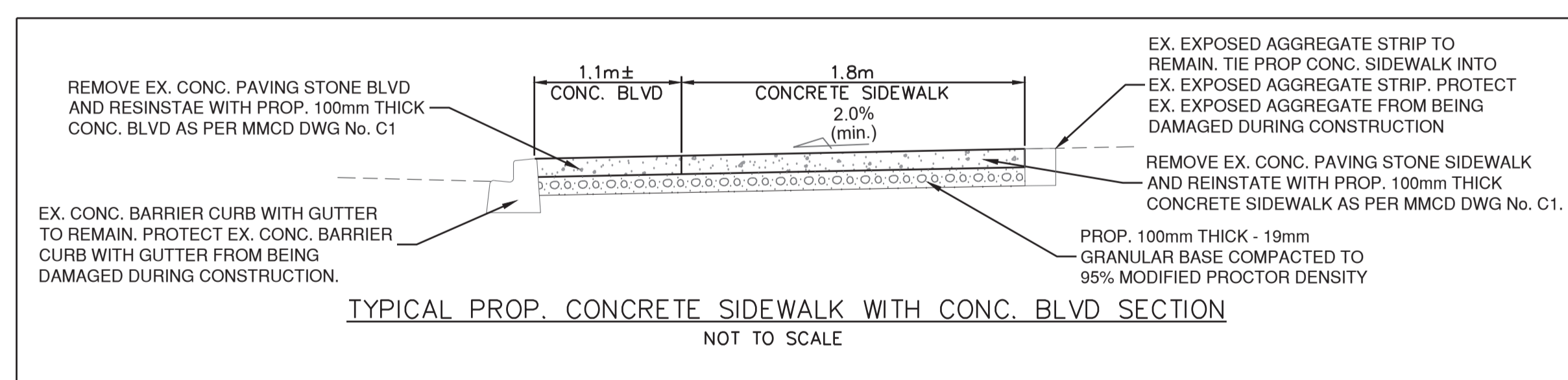

0 10m
 H 1:250
 V 1:25

DISCLAIMER:
 This drawing must not be reproduced without the written permission of R.F. Binnie & Associates Ltd.
 This drawing is not to be used for construction unless it is stamped "ISSUED FOR CONSTRUCTION" and signed by R.F. Binnie & Associates Ltd. It is the contractor's responsibility to ensure that he is in possession of the latest revision of this drawing.

Edge of pavement	Hydrant	Sanitary service	Hydro Guy Wire
Watermain and valve	Water air valve	Sanitary cleanout	Hydro Kiosk
Drainage sewer, MH	Water blowoff	Utility pole (joint pole)	Vegetation Conifer
Drainage ditch	Water service	Utility pole with light	Vegetation Deciduous
Sanitary sewer, MH	Catch basin, top inlet	Streetlight, down	Vegetation Shrub
Sanitary forcemain	Catch basin, side inlet	Streetlight, post top	Survey Traverse Hub
Gasmain and valve	Catch basin, round	Comb signal pole	Survey Iron Pin
Hydro duct, MH	Drainage service	Traffic signal pole	Survey Lead Plug
Telephone duct, MH	Drainage cleanout	Junction box	Survey Monument

No.	Date	By	Revisions
1	2026-04-21	PP	ADDENDUM 1
0	2026-03-31	PP	ISSUED FOR TENDER

Design by	Date
PP	2026-01-15
Drawn by	Date
MK	2026-01-13
Checked by	Date
WC	2026-03-31
Approved by	Date
KD	2026-01-30

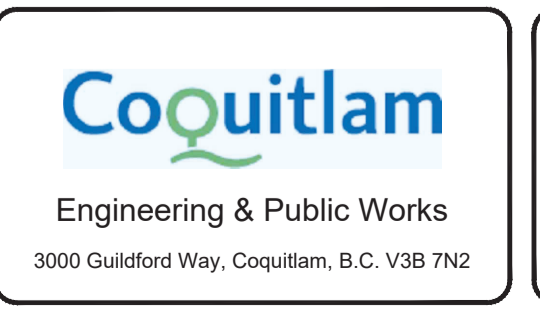

Scale	1:250	Scale	1:25
horiz.		vert.	
Sheet	05	of	06
Eng. Project No.	25-0704		

Project **ATLANTIC AVE**
SIDEWALK REPLACEMENT

Description **ROADWORKS - PLAN**

File: **25-0704-R2**

REV. **1**



EGBC PERMIT No. 1001128

ADDENDUM 1

BENCHMARK:
 MONUMENT 93H1001
 N: 5460550.827 E: 51617.196
 ELEV. = 17.923M (CVD28GVRD2018)

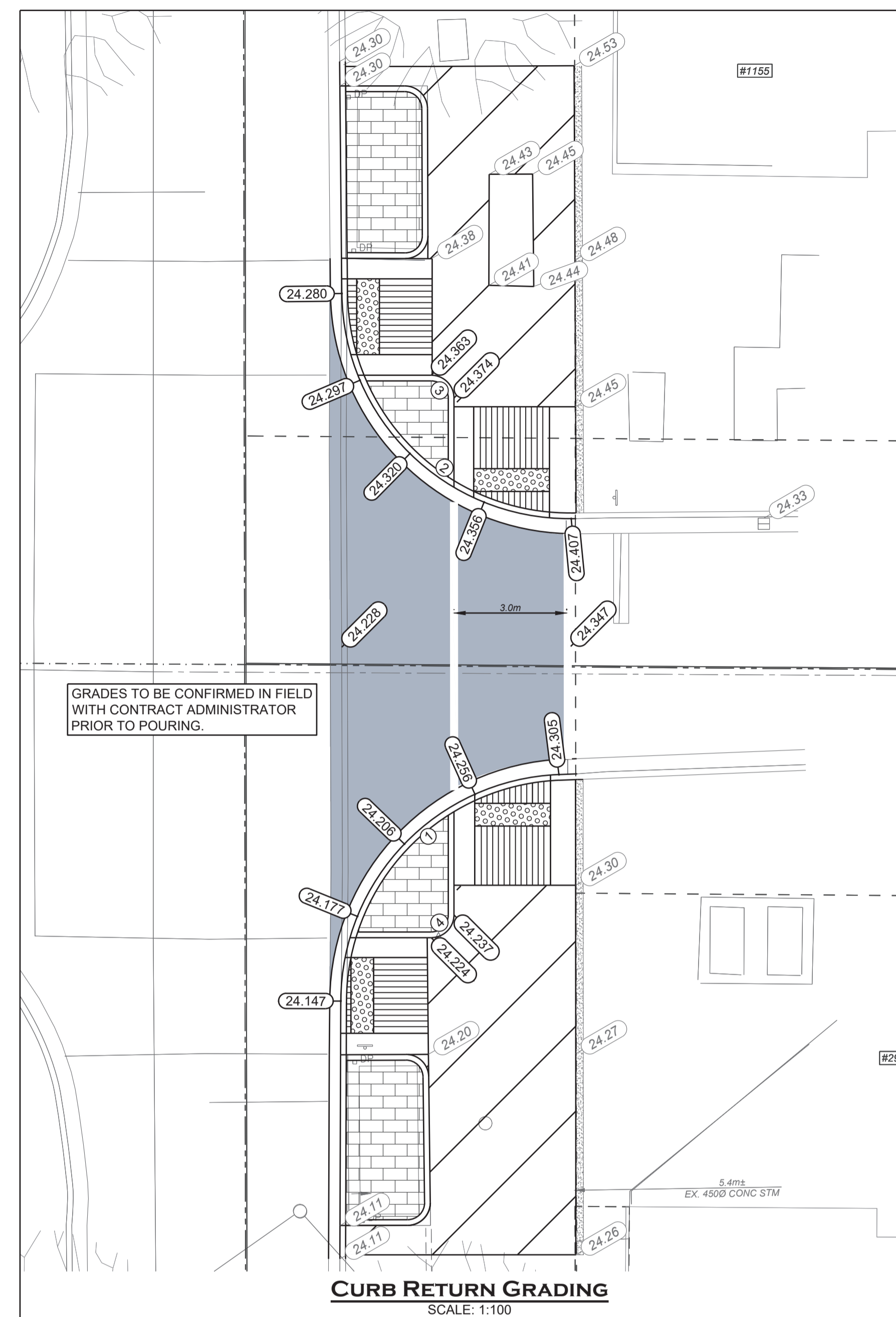
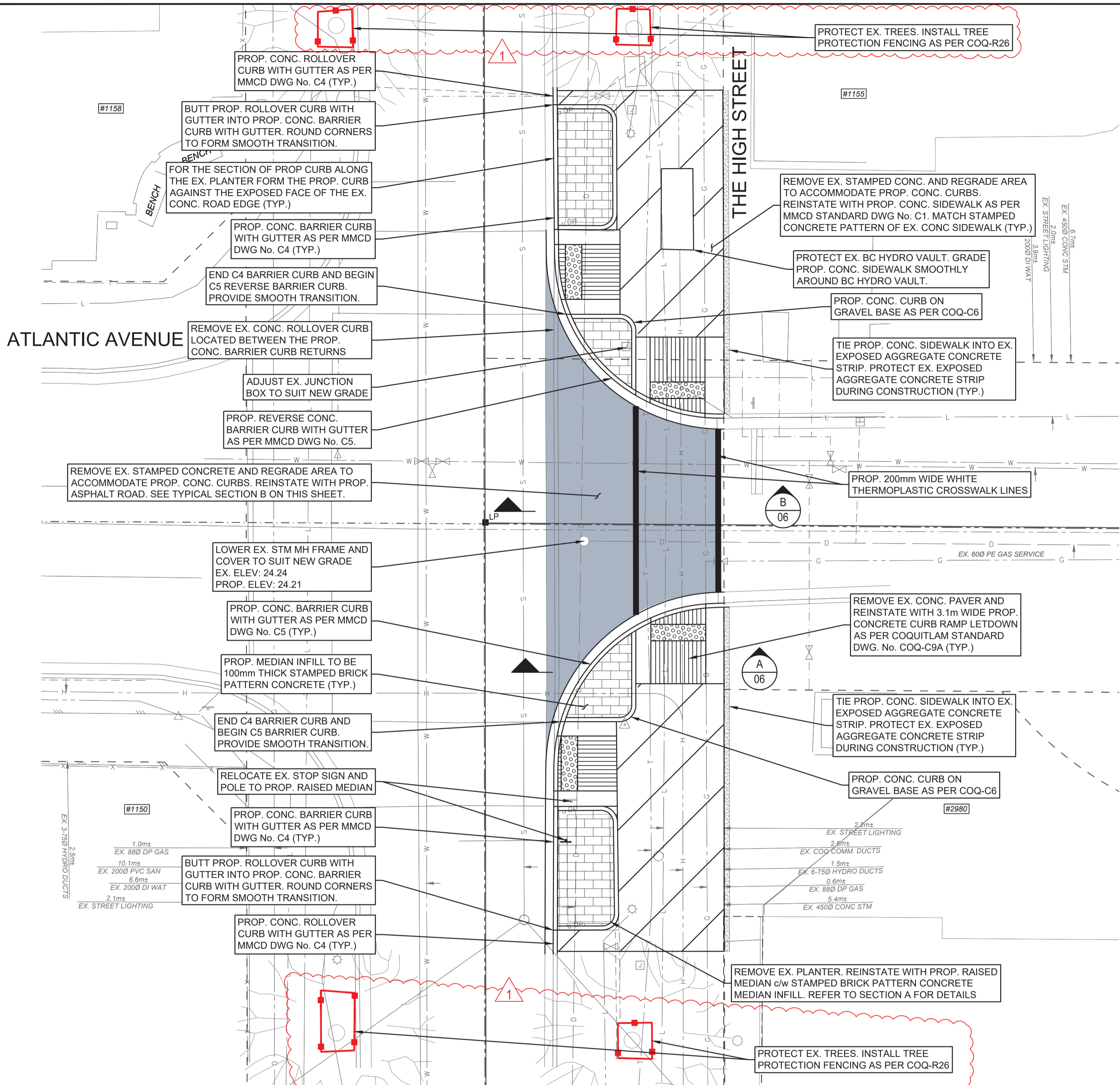

CURVE TABLE

CURVE No.	RADIUS	DELTA	LENGTH	BC NORTHING / EASTING	EC NORTHING / EASTING
1	6.000	87° 32' 09"	9.167	5460973.397 / 515041.690	5460979.375 / 515047.449
2	6.000	89° 59' 16"	9.424	5460992.070 / 515041.717	5460986.127 / 515047.772
3	0.600	90° 00' 00"	0.942	5460989.312 / 515044.677	5460989.912 / 515044.077
4	0.600	90° 00' 00"	0.942	5460975.070 / 515044.077	5460975.670 / 515044.677

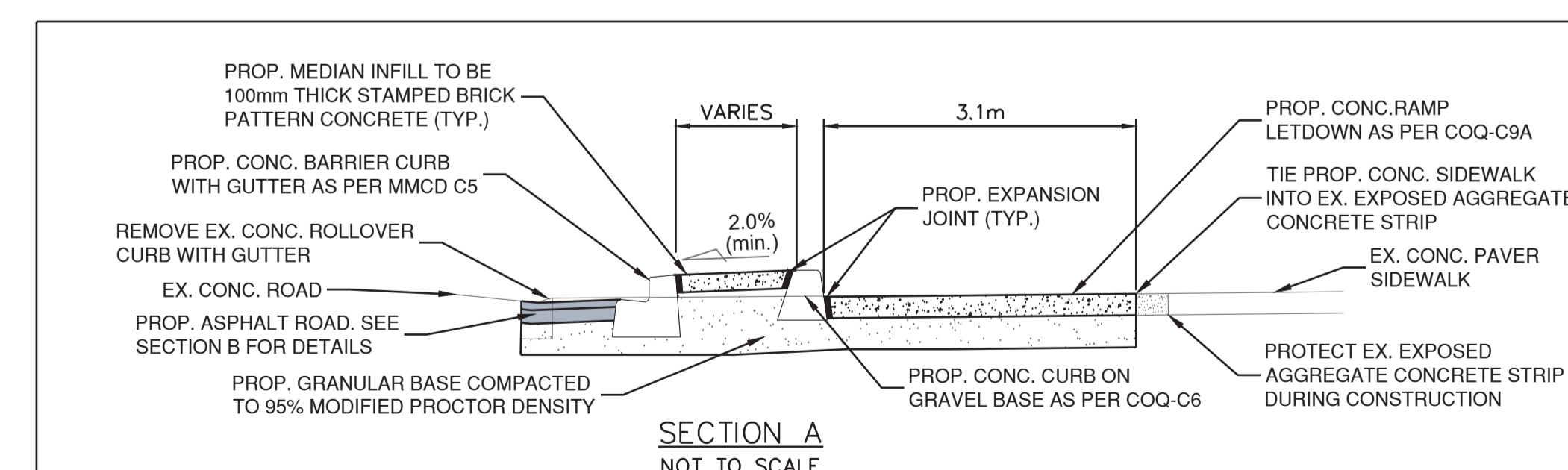
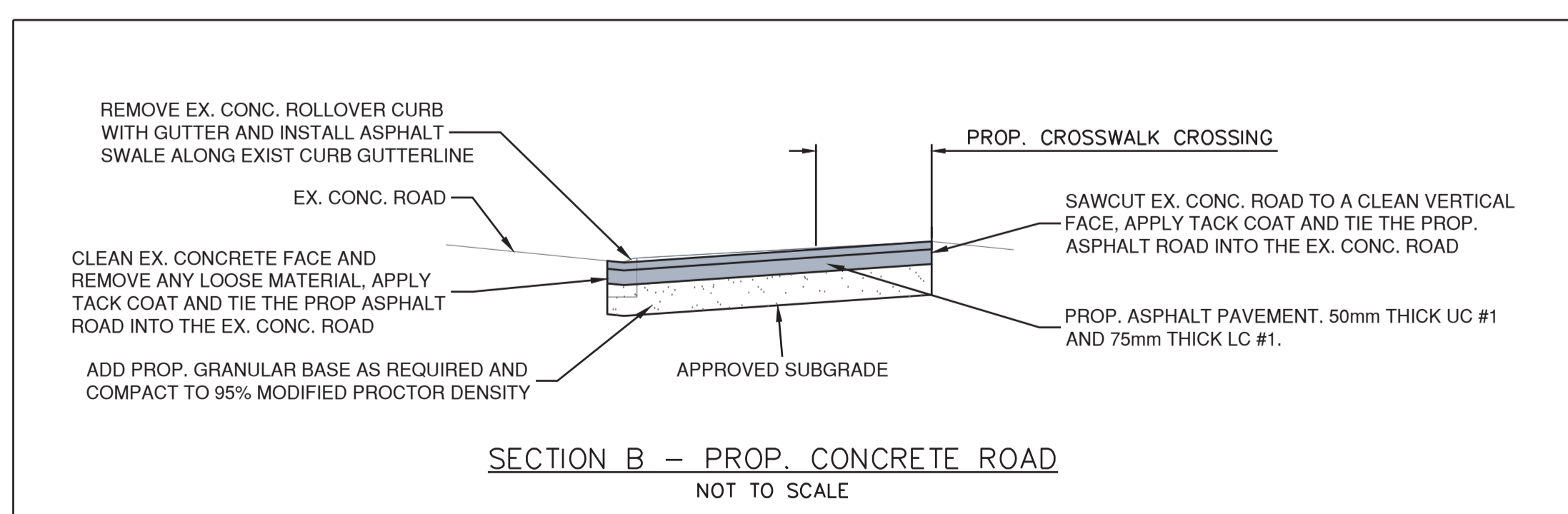

0 1:100 4m
 0 1:10 0.4m

DISCLAIMER: This drawing must not be reproduced without the written permission of R.F. Binnie & Associates Ltd. This drawing is not to be used for construction unless it is stamped "ISSUED FOR CONSTRUCTION" and signed by R.F. Binnie & Associates Ltd. It is the contractor's responsibility to ensure that he is in possession of the latest revision of this drawing.

Edge of pavement	Hydrant	Sanitary service	Hydro Guy Wire
Watermain and valve	Water air valve	Sanitary cleanout	Hydro Kiosk
Drainage sewer, MH	Water blowoff	Utility pole (joint pole)	Vegetation Canister
Drainage ditch	Water service	Utility pole with light	Vegetation Deciduous
Sanitary sewer, MH	Catch basin, top inlet	Streetlight, down	Vegetation Shrub
Sanitary forcemain	Catch basin, side inlet	Streetlight, post top	Survey Traverse Hub
Gasmain and valve	Catch basin, round	Comb signal pole	Survey Iron Pin
Hydro duct, MH	Drainage service	Traffic signal pole	Survey Lead Plug
Telephone duct, MH	Drainage cleanout	Junction box	Survey Monument

No.	Date	By	Revisions
1	2026-04-21	PP	ADDENDUM 1
0	2026-03-31	PP	ISSUED FOR TENDER

Design by	Date
PP	2026-01-15
Drawn by	Date
MK	2026-01-13
Checked by	Date
WC	2026-03-31
Approved by	Date
KD	2026-01-30



Scale horz. 1:100 Scale vert. 1:10
 Sheet 06 of 06
 Eng. Project No. 25-0704

Project ATLANTIC AVE AND THE HIGH ST
 INTERSECTION IMPROVEMENT
 Description ROADWORKS - PLAN
 File: 25-0704-R3
 REV. 1



EGBC PERMIT No. 1001128

ADDENDUM 1