



### Addendum No. 1

**City of Coquitlam  
Tender 77801  
3371 Mason Ave Frontage Improvements**

(Consists of 7 Pages)

Issue Date: January 18, 2022

Tenderers shall note the following changes:

#### Revisions

##### 1. Refer to: Agreement, AGT 6

###### REMOVE:

TITLE	SHEET NUMBER	REVISION DATE	REVISION NUMBER
MASON AVE AND HOLLYBROOK ST TO COAST MERIDIAN ROAD – ROADWORKS – PLAN & PROFILE	3 of 12	2021-11-08	5
MASON AVE - HOLLYBROOK ST TO COAST MERIDIAN – SERVICE CONNECTION - PLAN	10 of 12	2021-11-08	4

###### REPLACE with:

TITLE	SHEET NUMBER	REVISION DATE	REVISION NUMBER
MASON AVE AND HOLLYBROOK ST TO COAST MERIDIAN ROAD – ROADWORKS – PLAN & PROFILE	3 of 12	2022-01-10	6
MASON AVE - HOLLYBROOK ST TO COAST MERIDIAN – SERVICE CONNECTION - PLAN	10 of 12	2022-01-10	5

##### 2. Refer to: FORM OF TENDER

REMOVE: **Appendix 1**

REPLACE with: **Revised Appendix 1 - Revision No. 1**

#### Contractor Questions/Clarifications

- Q1) Sheet 02 Road details, cross section item 10, what material is approved for use as fill and how supply/installation to be paid?
- A1) 75mm minus granular sub base is approved and will be paid under Pay Item 9.01.**
- Q2) Sheet 1 of 12, General Construction Notes: "All work shall pass the inspection of the Engineering Department of the City of Coquitlam". What is this inspection based on and what are the criterias?
- A2) Inspection will be in accordance with MMCD and contract documents.**
- Q3) Supplementary Contract Specifications, Section 00 72 43S, Clause 1.18 dictates the sequence of work. Is the contractor responsible for the sequencing of the work or the City? Where did this sequence come from? Who is responsible for the work?
- A3) Contractor is to follow the sequencing listed in Clause 1.18, unless otherwise approved by the Contract Administrator. The sequencing listed was based on work previously completed by other contractors. Contractor is responsible for the construction means, methods, techniques, procedures and coordination of the work under the contract.**
- Q4) Can backfill / excavation material be stockpiled or it has to be removed daily?
- A4) Refer to Supplementary General Conditions, SGC 3, Clause 4.1.2.**

- Q5) Is daily cleaning and sweeping required. If not, who is making the decision and what is it based on?
- A5) Yes, daily cleaning and sweeping is required. Contractor is responsible to keep the site in a tidy condition. Refer to MMCD General Condition, Clause 4.1.2.**
- Q6) What is the interpretation of a "Change in Design" for City of Coquitlam? For example, is a change in elevation of a sidewalk / driveway consider a "Change in Design"? Can the CA decide not to send a drawing revision?
- A6) "Change in Design" is a significant alteration to the original design or for additional work not shown in contract drawings or described in contract documents. Adjustment in elevation of sidewalk/driveway is specified in the contract drawing and described in contract documents, and is not considered a "Change in Design". The need for a "Change in Design " will be determined by the Contract Administrator.**
- Q7) Can the Contract Administrator decide not to send a drawing revision?
- A7) Yes. Contract Administrator is only required to provide direction or clarification with the affected work. Providing drawing revision is at the sole discretion of the Contract Administrator.**
- Q8) Does the Contract Administrator require an additional survey to validate the elevation of the proposed sidewalk? If yes, should an additional mobilization of a surveyor be included in the price or it is going to be treated as an extra work?
- A8) Contractor is responsible for all survey layout and is included in the price. The layout includes, but not limited to, proposed sidewalk, curb and gutter, driveways and adjustments (i.e driveways, sidewalks, curb returns). If layout is complete, then there is no need for additional survey layout.**
- Q9) Sheet 1 of 12, Roadworks Notes, Item No. 21 " All changes are incidental to contract". What is the intent of this sentence, and what does it apply for?
- A9) Item No. 21 applies to all affected items under Roadworks Notes. It applies to the changes/adjustments as described from Item No. 1 to 2o.**
- Q10) Can you please confirm if the services have to be connected in the section "Not included in this contract" .
- A10) The two storm leads shall be connected to the storm main to the south. The new water service shall be connected to the 150mm watermain to the south. Refer to Sheets 3 of 12, Rev. 6 and 10 of 12, Rev. 5.**
- Q11) Does the linear meter price for Retention Trench include the excavation and backfill material ?
- A11) Yes. Refer to Form of Tender , Pay Item 18.03.**
- Q12) Is the contractor obligated to use the same unit rate even if it is provisional?
- A12) Yes. Provisional items shall only be used as directed and at the sole discretion of the Contract Administrator. See Supplementary General Conditions, Clause 7.4.2.**
- Q13) The contractor will be required to backfill all trenches in paved areas and place a temporary patch of 50mm of hot mix asphalt the same day the excavation is made. Does it include driveways?
- A13) Temporary asphalt patch on driveways is not required, but access must be maintained for property owners. Refer to Contract Specific Notations, Section 00 72 43S, Clause 1.17.**
- Q13) Driveway access testing and adjustments, who is making the decision on those adjustment and how is the contractor compensated for this work.
- A13) Contractor is responsible for testing and adjustments, and is inclusive in the pay item. Refer to Supplementary Contract Specifications, Concrete Walks, Curbs and Gutter, Section 03 30 20S, Clause 1.4.5.**
- Q14) Are the thickness noted under the typical section variables? Can they be removed from the contract if the existing material is found suitable? If yes can we modify the contract rates to allow for the design change?
- A14) Thickness is variable. Pay Items 9.01 and 10.01 are both provisional. Provisional items shall only be used as directed and at the sole discretion of the Contract Administrator. Contract rates identified as provisional cannot be modified.**
- Q15) Please identify the extent of the "nearby location" of catch basin that needs to be cleaned by a vacuum truck.
- A15) Extent of the nearby location will be up to the locations affected by the work. Any catch basins that are affected by the work will be considered to be nearby.**

---

Q16) Can we re-use native material?

**A16) Re-use of native material shall be at the sole discretion of the Contract Administrator.**

Q17) How do we get paid for driveway asphalt work?

**A17) Refer to Form of Tender, *Revised* Appendix 1 – **Revision No. 1**, Pay Item 11.02.**

---

***End of Addendum No. 1***

Tenderers shall take into account the content of this Addendum in the preparation and submission of the Tender which will form part of the contract and should be acknowledged on the Tender form where indicated.

Upon submitting a Tender, Tenderers will be deemed to have received all addenda and considered the information for inclusion in the Tender submitted.

*Issued by:*

M. Pain  
Purchasing Manager  
Email: [bid@coquitlam.ca](mailto:bid@coquitlam.ca)

**Revised APPENDIX 1 - Revision No. 1**  
**FORM OF TENDER**

**Contract 77801**

**3371 Mason Ave Frontage Improvements**

**SCHEDULE OF QUANTITIES AND PRICES**

(see paragraph 5.3.1 of the Instruction to Tenderers)

**(All Tender and Contract Prices shall NOT include GST. GST will apply upon payment)**

**(Should there be any discrepancy in the information provided, the City's original file copy shall prevail)**

ITEM NO.	MMCD Ref. / (Supplementary Contract Specifications)	DESCRIPTION	UNIT	QTY	UNIT PRICE	EXTENDED AMOUNT
<b>1.00</b>	<b>01 55 00</b>	<b>TRAFFIC CONTROL, VEHICLE ACCESS AND PARKING</b>				
1.01	1.5.1	Traffic Control and Management				Incidental to Contract
<b>2.00</b>	<b>01 57 015</b>	<b>ENVIRONMENTAL PROTECTION</b>				
2.01	(1.6.1)	ESC supply & installation, maintenance and removal				Incidental to Contract
<b>3.00</b>	<b>01 58 015</b>	<b>PROJECT IDENTIFICATION</b>				
3.01	(1.3.1)	Construction Zone Information Signs	ea.	3		
<b>4.00</b>	<b>03 30 205</b>	<b>CONCRETE WALKS, CURBS AND GUTTERS</b>				
4.01	(1.4.3)	Concrete Curb & Gutter - Wide Base - MMCD C5	l.m	225		
4.02	(1.4.5)	Concrete Sidewalk & Walkway connectors & Wheelchair Letdown - 100mm thick - Broom Finished c/w 100mm Granular base; and as shown and described in the Contract Documents	sq.m	340		
4.03	(1.4.5)	Concrete Driveway Letdown, Sidewalk Crossing, and Driveways - COQ-C7 & COQ-C7B - 190mm thick c/w 100mm granular base; and as shown and described in the Contract Documents	sq.m	30		
4.04	(1.4.10)	Tactile Strip - 24x60in - Access Tile, Yellow color - removable type	ea.	4		
<b>5.00</b>	<b>26 56 015</b>	<b>ROADWAY LIGHTING</b>				
5.01	1.9.2	Supply & installation of Roadway Lighting (ALL) Works including any removal, adjustments and disposal needed to complete the work and as shown on the Contract Drawing	l.s.	1		
<b>6.00</b>	<b>31 11 015</b>	<b>CLEARING AND GRUBBING</b>				
6.01	(1.4.1)	Clearing & grubbing	l.s.	1		
6.02	1.4.2	Tree removal	l.s.	1		
<b>7.00</b>	<b>31 24 135</b>	<b>ROADWAY EXCAVATION, EMBANKMENT AND COMPACTION</b>				
7.01	(1.8.4)	Removal and disposal of Existing Asphalt (all Depths), including asphalt curb, concrete, paver or sidewalks	sq.m	30		
7.02	(1.8.5)	Common Excavation including Off Site Disposal(includes retaining wall) (Provisional)	cu.m	540		
<b>8.00</b>	<b>32 01 16.75</b>	<b>COLD MILLING</b>				
8.01	1.5.1	Full depth milling	sq.m	570		
<b>9.00</b>	<b>32 11 16.15</b>	<b>GRANULAR SUBBASE</b>				
9.01	(1.4.3)	75mm Minus Granular Sub Base, variable thickness (Provisional)	tonne	345		
<b>10.00</b>	<b>32 11 235</b>	<b>GRANULAR BASE</b>				
10.01	(1.4.3)	25mm Minus Granular Base, variable thickness (Provisional)	tonne	295		
<b>11.00</b>	<b>32 12 165</b>	<b>HOT-MIX ASPHALT CONCRETE PAVING</b>				
11.01	(1.5.1)	Asphaltic Concrete Paving - Machine Laid Upper Course #1 (75mm, 1 lift)	tonne	210		
11.02	(1.5.3)	Asphaltic Concrete Paving (driveway) - MMCD UC#1 (75mm, 1 lift) (c/w 100mm granular base)	tonne	5		
<b>12.00</b>	<b>32 17 235</b>	<b>PAINTED PAVEMENT MARKINGS</b>				
12.01	(1.5.3)	Supply & Installation Thermoplastic Pavement Markings	l.s.	1		
12.02	(1.5.4)	Remove and Reinststate existing signage	ea.	3		
<b>13.00</b>	<b>32 31 13</b>	<b>CHAIN LINK FENCES AND GATES</b>				
13.01	1.5	Removable Steel Bollards - Model R-901 c/w base receiver. Refer to Appendix B.	ea.	2		
<b>14.00</b>	<b>32 91 215</b>	<b>TOP SOIL AND FINISH GRADING</b>				
14.01	(1.4.1)	Imported Topsoil - 150mm Thick for Sod	cu.m	38		
14.02	(1.4.1)	Growing Medium - Boulevard Tree Planting Trench - includes excavation, backfill, growing medium and as shown in Contract Drawings and described in Contract Documents(not paid where Boulevard Retention Trench is installed)	cu.m	255		
14.03	(1.4.1)	50mm Bark mulch (Provisional)	cu.m	2		
<b>15.00</b>	<b>32 92 235</b>	<b>SODDING</b>				
15.01	(1.8.1)	Sodding	sq.m	495		
<b>16.00</b>	<b>32 93 015</b>	<b>PLANTING OF TREES, SHRUBS, AND GROUND COVERS</b>				
16.01	(1.9.1)	Carpinus Betulus Globosum (Globe European Hornbeam) 7cm Cal/B&B 2.0m STD.	ea.	6		

ITEM NO.	MMCD Ref. / (Supplementary Contract Specifications)	DESCRIPTION	UNIT	QTY	UNIT PRICE	EXTENDED AMOUNT
16.02	(1.9.1)	Magnolia Kobus (Kobus Magnolia) 7cm Cal/B&B 2.0m STD.	ea.	3		
16.03	(1.9.1)	Fagus Sylvatica 'Dawyck' (Dawyck Beech) 7cm Cal/B&B 2.0m STD.	ea.	4		
16.04	(1.9.3)	400mm Deep Root barrier, 3m each side of tree (Provisional)	l.m	150		
<b>17.00</b>	<b>33 11 01S</b>	<b>WATERWORKS</b>				
17.01	(1.8.4)	50mm Service Connections - COQ-W2e as shown in Contract Drawings and as per Appendix B	ea.	1		
<b>18.00</b>	<b>33 40 01S</b>	<b>STORM SEWERS</b>				
18.01	(1.6.3)	Storm Service Connection c/w Inspection Chamber	ea.	1		
18.02	(1.6.5)	Catch Basin/Lawn Basin connection - 150mm SDR28 PVC (including sanded stubs)	l.m	14		
18.03	(1.6.6)	Boulevard Retention Trench - COQ-SW3/SW4 (includes excavation, backfill materials, growing medium)	l.m	90		
18.04	(1.6.6)	Boulevard Retention Trench - Decant Piping (includes perf pipe, caps, cleanout, trench dam and tie in to C/B)	ea.	1		
<b>19.00</b>	<b>33 44 01S</b>	<b>MANHOLES AND CATCHBASINS</b>				
19.01	(1.5.2)	Top Inlet Catch Basin with 600mm Offsite Manhole - COQ-S11B (Provisional)	ea.	1		
19.02	(1.5.2)	Top Inlet Catch Basin MMCD S11	ea.	2		
19.03	(1.5.2)	Lawn Basin - COQ-S12A Type 1, 300mm c/w bottom, as per Appendix B	ea.	1		
19.04	(1.5.3)	Manhole Frame and Lid Adjustments Only (Provisional)	ea.	5		
19.05	(1.5.3)	Manhole Frame and Lid Replacement & Adjustments (Provisional)	ea.	5		
19.06	1.5.4	Removal, Capping & Disposal of Catch Basins	ea.	1		

Total Tendered Price (exclude GST): \$ \_\_\_\_\_

(Transfer the amount to Form of Tender Summary Page 1)

Name of Contractor: \_\_\_\_\_

- PROOF ROLL BASE, ADD GRAVELS AS REQUIRED, RECOMPACT, AND RESHAPE AS REQUIRED PRIOR TO PAVING.
- CLEAN AND TACK-COAT ALL ASPHALT SURFACES INCLUDING JOINTS PRIOR TO PAVING.
- COMPACTION FOR GRAVELS 95% M.P.D., FOR MARSHALL MIX 97% (TYP.)
- OVER-EXCAVATE (OPTIONAL):  
WHERE DIRECTED BY THE CA, EXCAVATE UNSUITABLE MATERIAL AND REPLACE WITH IMPORTED BASE GRAVEL COMPACTED IN PLACE.
- CONTRACTOR TO REPLACE ALL MANHOLE FRAMES AND LIDS; WATER VALVE BOXES AND COVERS WITHIN THE ROADWAY.
- THE ADJUSTMENT OF MANHOLES, VALVE COVERS, AND ALL OTHER APPURTENANCES TO SUIT NEW ASPHALT GRADES IS INCIDENTAL TO ASPHALT PAVING UNLESS SPECIFIED OTHERWISE IN THE SCHEDULE OF QUANTITIES. (TYP.)
- ALL PAVEMENT MARKINGS TO BE REINSTATED IN THE PLACE OF WORK. CONTRACTOR RESPONSIBLE TO PERFORM PRE AND POST CONSTRUCTION SURVEY WORK ESSENTIAL FOR THE REINSTATEMENT OF PAVEMENT MARKINGS.
- CONTRACTOR TO IDENTIFY ANY SURVEY MONUMENTS AND LEAD PLUGS THAT MAY BE DISTURBED DURING CONSTRUCTION AND ARRANGE WITH THE OWNER'S SURVEY DEPARTMENT 5 DAYS PRIOR TO CONSTRUCTION TO REFERENCE LOCATIONS BEFORE WORK COMMENCES.
- CATCH BASINS RIM ELEVATIONS TO BE SET 30mm BELOW THE FINISHED GUTTERLINE GRADES. GUTTER AND ROAD SURFACE AREA TO BE SHAPED TO FORM A DISH AROUND THE INLET.
- FINAL LAYOUT OF LETDOWN AND TACTILE TO BE APPROVED BY CA. ADJUSTMENTS TO BE MADE ON SITE (TYP.)
- SIDEWALK PANELS TO BE THICKEN TO 190mm ON ALL LETDOWN CROSSINGS, UP TO ONE PANEL PAST THE CURB RAMP (TYP.)

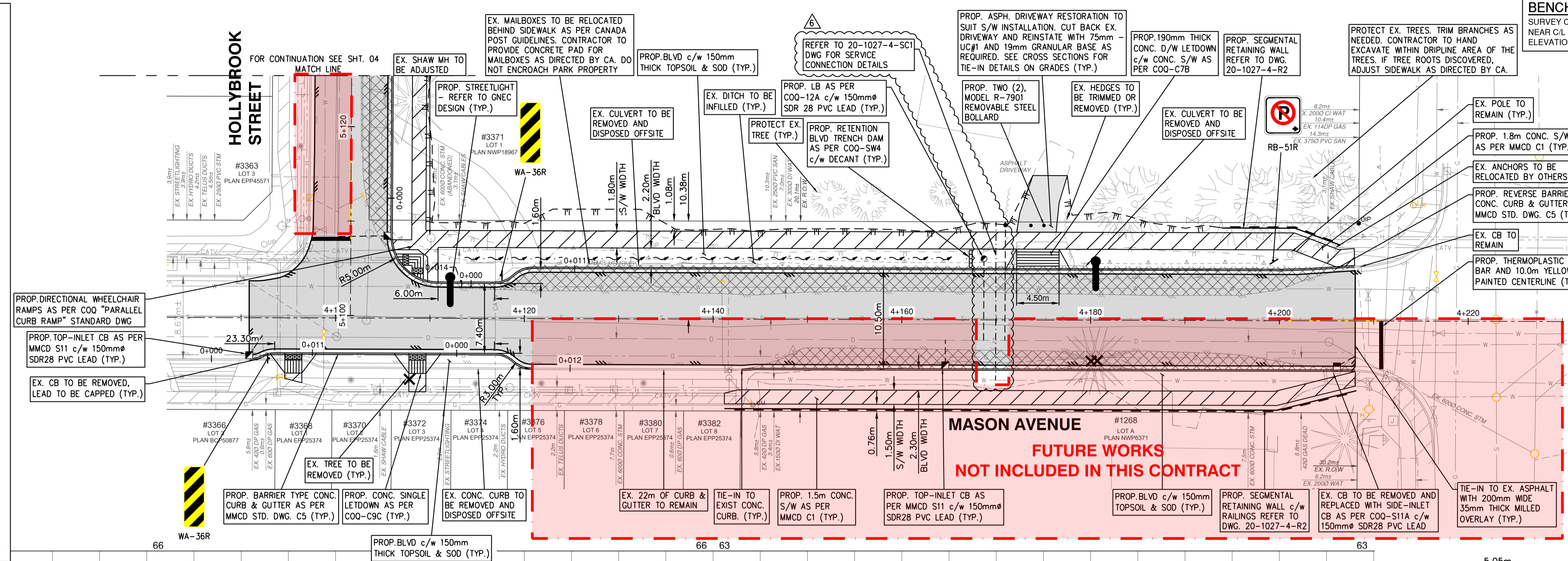

**BENCHMARK:**  
SURVEY CONTROL MONUMENT 75H3703  
NEAR C/L OF MASON AVE, CLOSE TO W. BARRIER  
ELEVATION = 67.606M

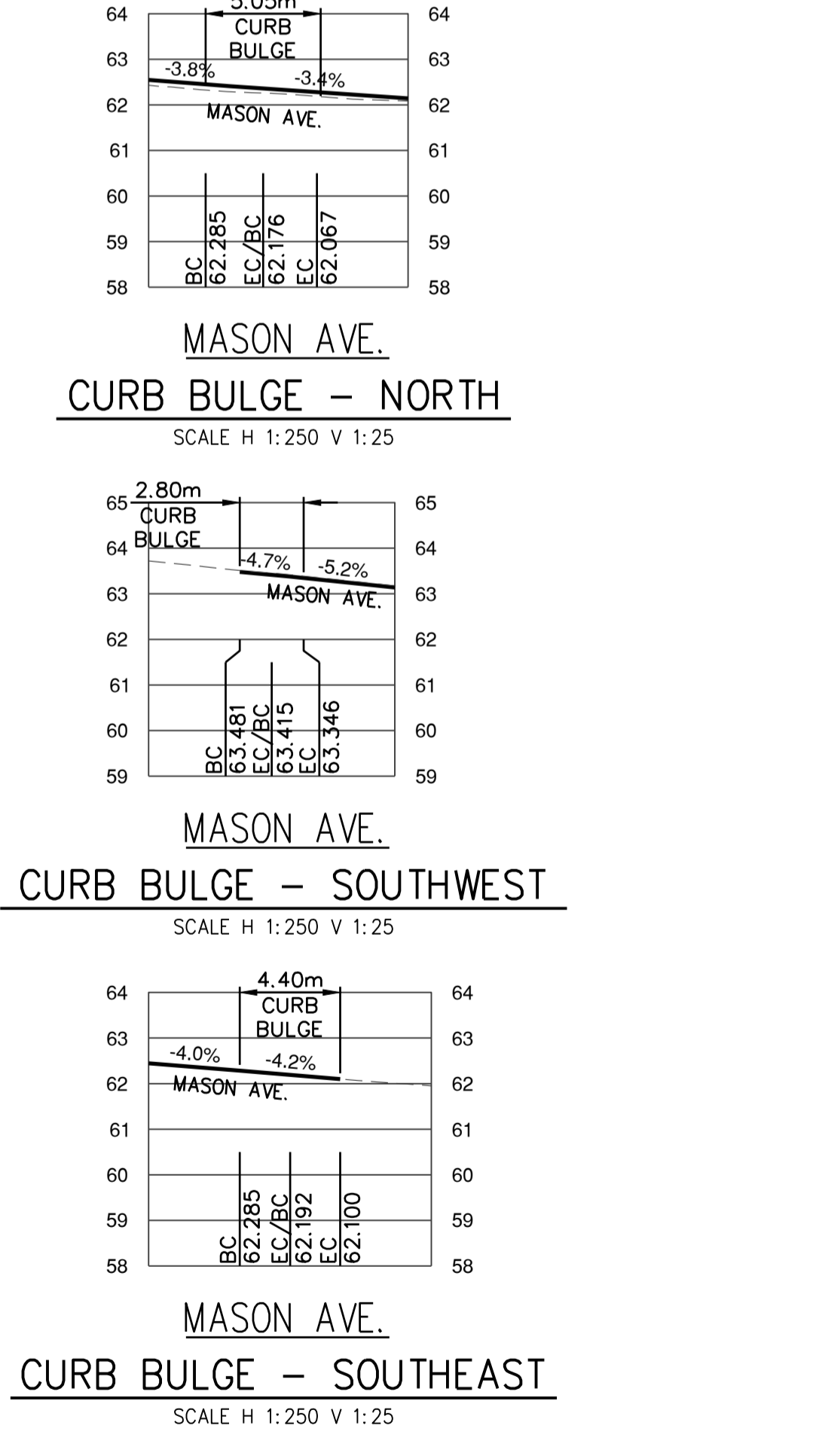
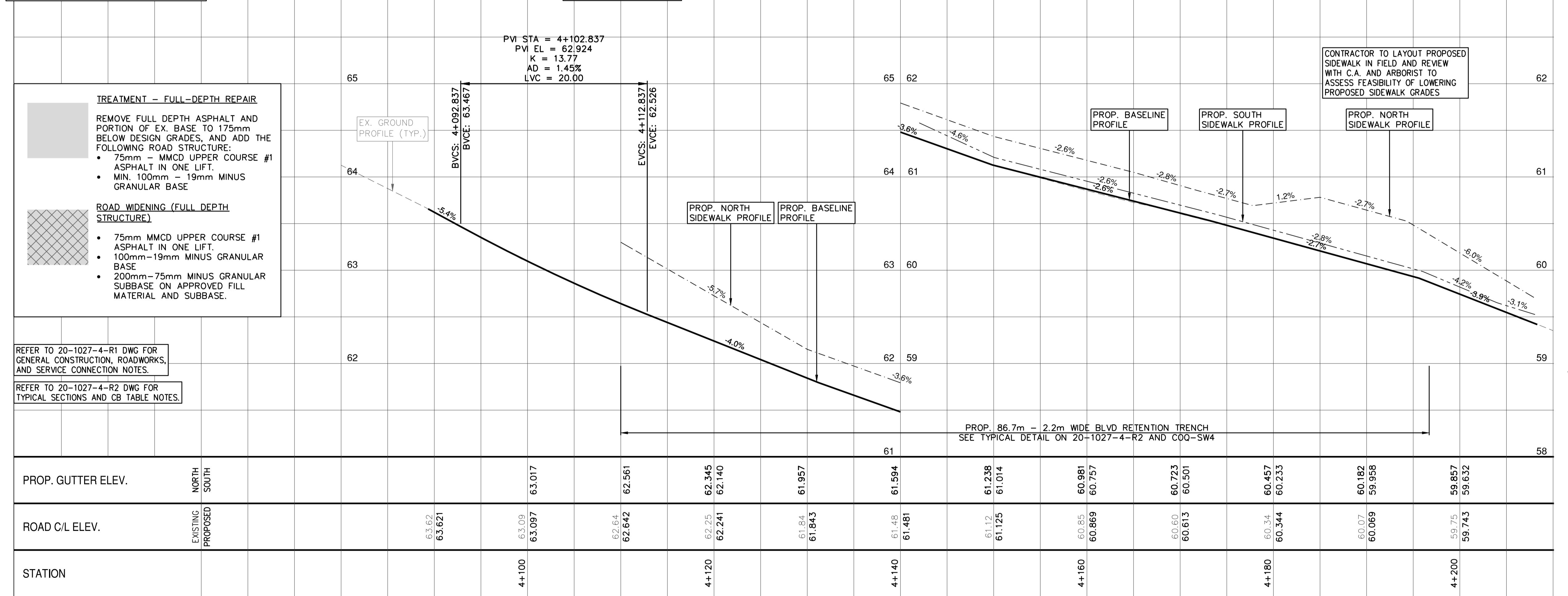

- TREATMENT - FULL-DEPTH REPAIR**
- REMOVE FULL DEPTH ASPHALT AND PORTION OF EX. BASE TO 175mm BELOW DESIGN GRADES, AND ADD THE FOLLOWING ROAD STRUCTURE:
- 75mm - MMCD UPPER COURSE #1 ASPHALT IN ONE LIFT.
  - MIN. 100mm - 19mm MINUS GRANULAR BASE
- ROAD WIDENING (FULL DEPTH STRUCTURE)**
- 75mm MMCD UPPER COURSE #1 ASPHALT IN ONE LIFT.
  - 100mm - 19mm MINUS GRANULAR BASE
  - 200mm - 75mm MINUS GRANULAR SUBBASE ON APPROVED FILL MATERIAL AND SUBBASE.

REFER TO 20-1027-4-R1 DWG FOR GENERAL CONSTRUCTION, ROADWORKS, AND SERVICE CONNECTION NOTES.

REFER TO 20-1027-4-R2 DWG FOR TYPICAL SECTIONS AND CB TABLE NOTES.

PROP. GUTTER ELEV.	NORTH		SOUTH	
	EXISTING	PROPOSED	EXISTING	PROPOSED
			63.62	63.621
			63.09	63.097
			62.64	62.642
			62.25	62.241
			61.84	61.843
			61.48	61.481
			61.12	61.125
			60.85	60.869
			60.60	60.613
			60.34	60.344
			60.07	60.069
			59.75	59.857
			59.43	59.632

0 H 1:250 10m  
0 V 1:25 1m

DISCLAIMER: This drawing must not be reproduced without the written permission of R.F. Binnie & Associates Ltd. This drawing is not to be used for construction unless it is stamped "ISSUED FOR CONSTRUCTION" and signed by R.F. Binnie & Associates Ltd. It is the contractor's responsibility to ensure that he is in possession of the latest revision of this drawing.

Edge of pavement	Hydrant	Sanitary service	Hydro Guy Wire
Watermain and valve	Water air valve	Sanitary cleanout	Hydro Kiosk
Drainage sewer, MH	Water blowoff	Utility pole (joint pole)	Vegetation Canister
Drainage ditch	Water service	Utility pole with light	Vegetation Deciduous
Sanitary sewer, MH	Catch basin, top inlet	Streetlight, sign	Vegetation Shrub
Sanitary forcemain	Catch basin, side inlet	Streetlight, post top	Survey Traverse Hub
Gasmain and valve	Catch basin, round	Comb signal pole	Survey Iron Pin
Hydro duct, MH	Drainage service	Traffic signal pole	Survey Lead Plug
Telephone duct, MH	Drainage cleanout	Junction box	Survey Monument

No.	Date	By	Revisions
6	2022-01-10	KD	ADDENDUM NO. 1
5	2021-11-08	KD	ISSUED FOR TENDER
4	2021-07-22	KD	100% DETAILED DESIGN SUBMISSION
3	2021-06-04	KD	90% DETAILED DESIGN SUBMISSION
2	2021-03-26	KD	75% DETAILED DESIGN SUBMISSION
1	2021-03-09	VL	ISSUED FOR CONCEPTUAL REVIEW

Design by	Date
VL	
Drawn by	Date
KD	
Checked by	Date
TDB	
Approved by	Date
TDB	

The people behind your infrastructure.  
TEL 604 420 1721 BINNIE.com

Engineering & Public Works  
3000 Guildford Way, Coquitlam, B.C. V3B 7N2

Scale **1:250** Scale **1:25**  
horiz. Sheet **03** of **12**  
vert. Eng. Project No. **20-1027**

Project **MASON AVE  
HOLLYBROOK ST TO COAST MERIDIAN RD**  
Description **ROADWORKS - PLAN & PROFILE**  
File: 20-1027-4-R3  
REV. **6**

ISSUED FOR TENDER

**BENCHMARK:**  
 SURVEY CONTROL MONUMENT 75H3703  
 NEAR C/L OF MASON AVE, CLOSE TO W. BARRIER  
 ELEVATION = 67.606M

REFER TO SHEET 01 FOR  
 SERVICE CONNECTION NOTES

CONTRACTOR TO USE EXTREME CAUTION WHEN WORKING IN THE  
 VICINITY OF A RETAINING WALL AND/OR ADJACENT STRUCTURE.

THE CONTRACTOR IS REQUIRED UNDER PART 20.78 OF THE  
 WORKSAFE BC REGULATIONS TO ENGAGE THE SERVICES OF A  
 QUALIFIED REGISTERED PROFESSIONAL WHEN EXCAVATING ADJACENT  
 TO AN EXISTING STRUCTURE.

NO WORK IS TO PROCEED IN THE VICINITY OF THE STRUCTURE  
 WITHOUT WRITTEN INSTRUCTIONS FROM THE QUALIFIED REGISTERED  
 PROFESSIONAL AND SUCH COPY SUBMITTED TO THE CONTRACT  
 ADMINISTRATOR.

SAFE WORK PRACTICES FOR HANDLING ASBESTOS: WHEN  
 ENCOUNTERED THE CONTRACTOR SHALL ABIDE BY/FOLLOW ALL  
 REGULATIONS AS SET FORTH AND REQUIRED BY WORKSAFE BC FOR  
 THE SAFE HANDLING OF ASBESTOS. FOR FURTHER INFORMATION  
 REGARDING THE SAFE WORK PRACTICES FOR HANDLING ASBESTOS  
 THE CONTRACTOR SHALL CONTACT WORKSAFE BC FOR  
 CLARIFICATION.

PRE-LOCATE ALL EXISTING UTILITIES AND AFFECTED SERVICES  
 PRIOR TO CONSTRUCTION. LOCATION OF SERVICE CONNECTIONS  
 HAVE BEEN DERIVED FROM CITY OF COQUITLAM RECORDS AND ARE  
 FOR GUIDANCE ONLY.

ALL EXCAVATION WITHIN EXISTING TREE DRILINES WHERE TREES  
 ARE TO BE RETAINED SHALL BE BY HAND OR HYDRO-VAC.

LEGEND:

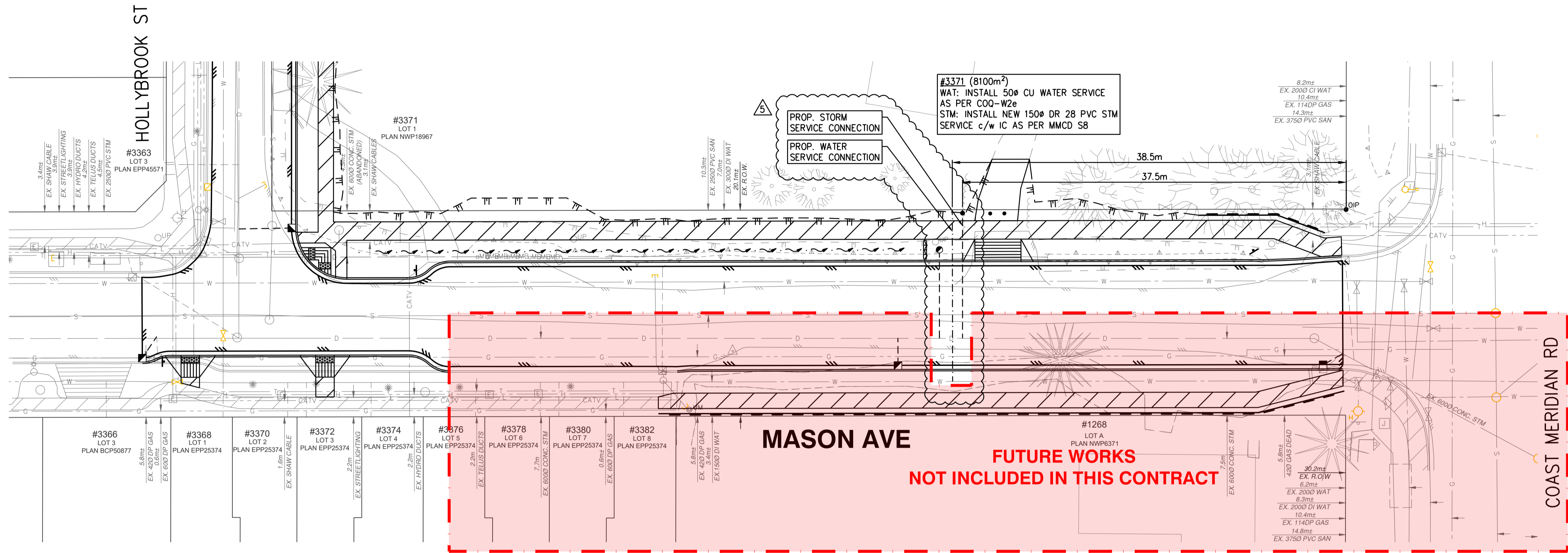
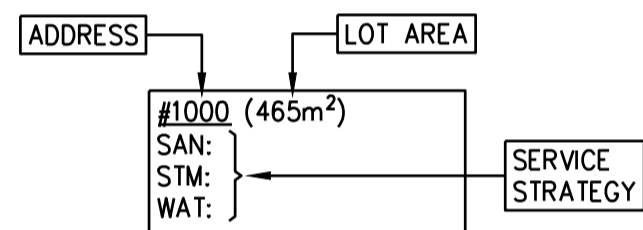

0 H 1:250 10m  
 0 V 1:25 1m  
 DISCLAIMER:  
 This drawing must not be reproduced without the written permission of R.F. Binnie & Associates Ltd.  
 This drawing is not to be used for construction unless it is stamped "ISSUED FOR CONSTRUCTION" and signed by R.F. Binnie  
 & Associates Ltd. It is the contractor's responsibility to ensure that he is in possession of the latest revision of this drawing.

Edge of pavement	Hydrant	Sanitary service	Hydro Guy Wire
Watermain and valve	Water air valve	Sanitary cleanout	Hydro Kiosk
Drainage sewer, MH	Water blowoff	Utility pole (joint pole)	Vegetation Conifer
Drainage ditch	Water service	Utility pole with light	Vegetation Deciduous
Sanitary sewer, MH	Catch basin, top inlet	Streetlight, post	Vegetation Shrub
Sanitary forcemain	Catch basin, side inlet	Streetlight, post top	Survey Traverse Hub
Gasmain and valve	Catch basin, round	Comb signal pole	Survey Iron Pin
Hydro duct, MH	Drainage service	Traffic signal pole	Survey Lead Plug
Telephone duct, MH	Drainage cleanout	Junction box	Survey Monument

No.	Date	By	Revisions
5	2022-01-10	KD	ADDENDUM NO. 1
4	2021-11-08	KD	ISSUED FOR TENDER
3	2021-07-22	VL	100% DETAILED DESIGN SUBMISSION
2	2021-06-04	VL	90% DETAILED DESIGN SUBMISSION
1	2021-03-26	KD	75% DETAILED DESIGN SUBMISSION

Design by	Date
VL	
Drawn by	Date
KD	
Checked by	Date
TDB	
Approved by	Date
TDB	

**BINNIE**  
 The people behind your infrastructure.  
 TEL 604 420 1721 BINNIE.com

**Coquitlam**  
 Engineering & Public Works  
 3000 Guildford Way, Coquitlam, B.C. V3B 7N2

Scale	1:250	Scale	1:25
horiz.		vert.	
Sheet	10	of	12
Eng. Project No.	20-1027		

Project **MASON AVENUE**  
**HOLLYBROOK ST TO COAST MERIDIAN RD**  
 Description **SERVICE CONNECTION - PLAN**  
 File: 20-1027-4-SC1  
 REV. 5

ISSUED FOR TENDER